

Composite sheet CS48-36-750

Ruukki's Composite profile CS48-36-750 is intended to be used as reinforcement in concrete slabs. During casting the sheet works as formwork, Steelcomp can be used as a ceiling surface beneath the slab due to its aesthetic design; and therefore, a suspended ceiling is not necessary needed.

Applications:

- Office construction
- Public construction
- Industrial construction
- Warehouse construction
- Renovation construction



[SEND CONTACT REQUEST](#)

Properties

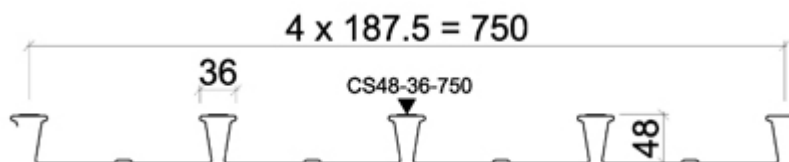

Model name	Composite sheet CS48-36-750
Product code	CS48-36-750
Height	48 mm
Width of crown	36 mm
Effective width	750 mm
Minimum length	400 mm
Maximum Length	12000 mm
Quality control	Factory production control according to EN 1090-1 and EN 1090-4
Tolerances	Dimensions and shape according to EN 1090-4, material thickness according to EN 10143
CE Marking	EN1090-1
Execution class	EXC1, EXC2, EXC3

Materials

Material thickness (mm)	Steel grade	Zinc (g/m ²)	Surface treatment	Corrosion class, interior	Corrosion class, exterior	Colours	Weight (kg/m ²)
0.7	S350	Z275	Galvanized	C2	-	-	9.16
0.9	S350	Z275	Galvanized	C2	-	-	11.78

0.9	S350	Z275	Polyester	C3	C3	RR2 0	11.78
1.1	S350	Z275	Galvanized	C2	-	-	14.39
1.1	S350	Z275	Polyester	C3	C3	RR2 0	14.39

Note: The reverse sides of the colour coated sheets are painted as standard with 2-layer grey backside coating

Design tools

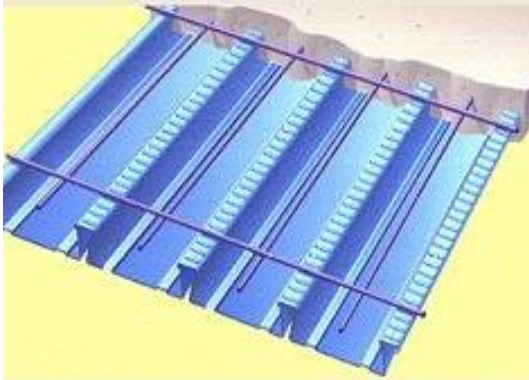

ComSlab software for designing composite slabs

The software is meant to be used as a design tool for Ruukki's SteelComp composite slabs. The complete capacity verification for a composite slab can be done, including also design for fire exposure. The user can optimise the construction during the design and select the cost-optimal composite slab for each application.

[Go to ComSlab software](#)

Technical documents

Here you can find all technical documents related to Ruukki's load-bearing sheets. Documents are organised by document type. Click to enter document library.

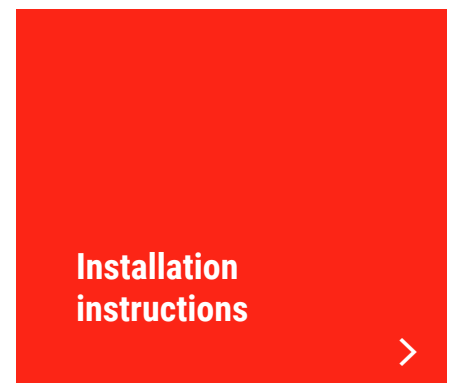
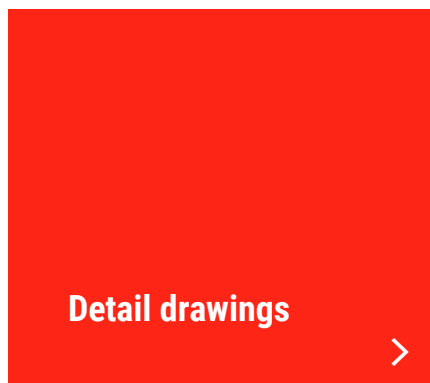
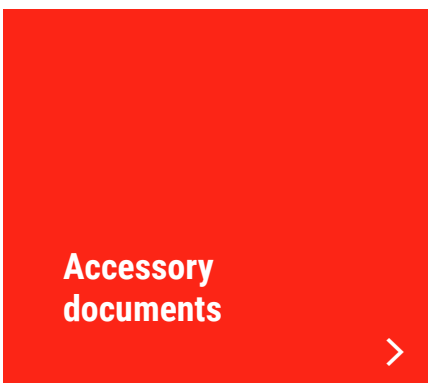

**Maintenance
instructions**



Certificates and approvals

Here you can find all certificates and approvals related to Ruukki's load-bearing sheets. Documents are organised by document type. Click to enter document library.

**Declaration of
performance**



**Environmental
product declaration**

