

## INSTRUCTIONS FOR FASTENING THE PANEL AND FOLLOW-UP OF THE DIMENSIONS

### FACADE CLADDINGS / CLADDING LAMELLAS LAMELLA GROOVE 30

# RUKKI

#### FASTENING OF THE LAMELLA

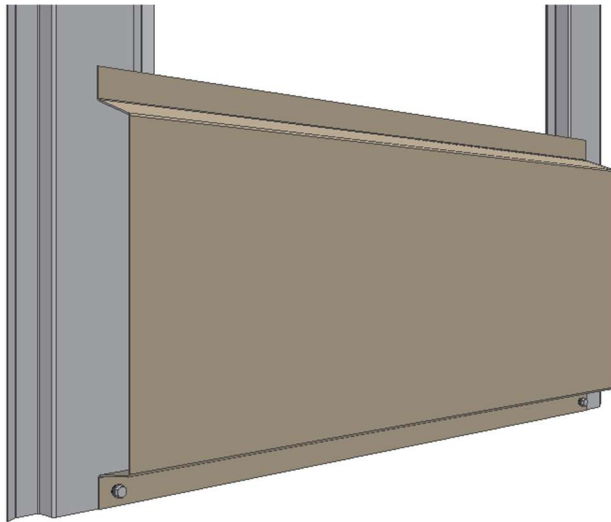

1. Add fasteners to the lower edge of the lamella, the joint should be at the center of the stud.

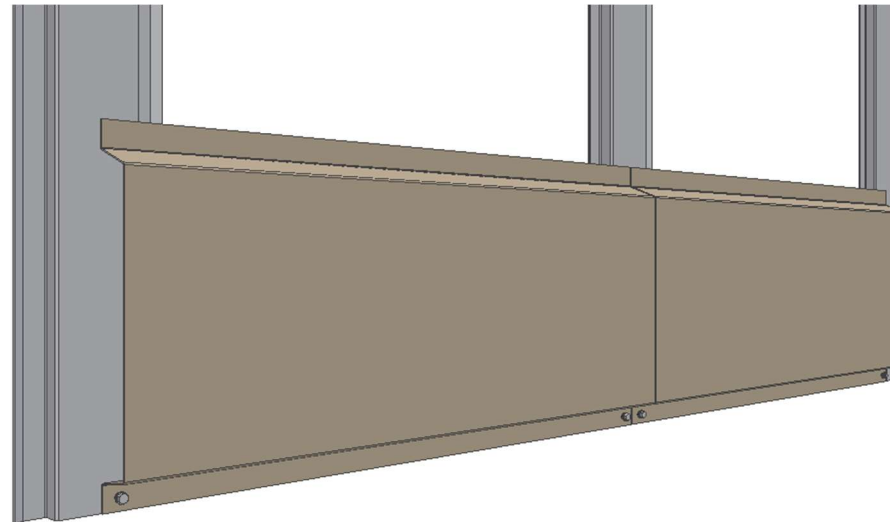

2. Continue installing the first row. Leave a 2-3 mm vertical gap between them for thermal expansion.

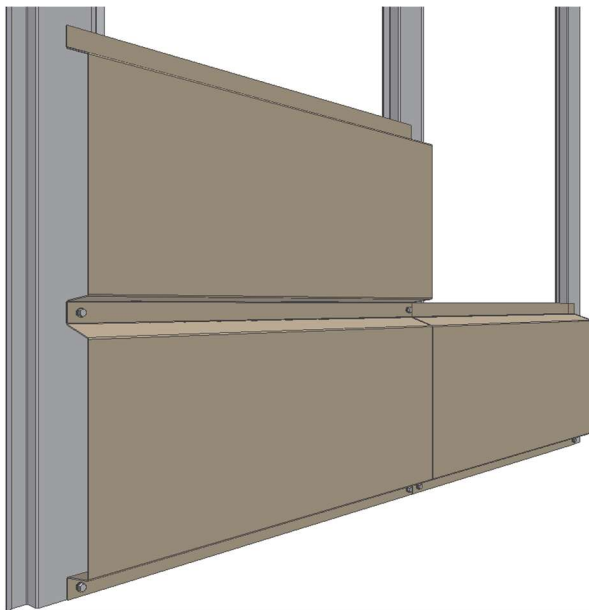

3. Install next row of lamellas by placing them on top of the bottom lamella and fastening through both flanges.

#### Recommended fasteners:

- For fastening to support stud (e.g. CA1SS1), use screws S3H48022D02S4C  
→ Note: This screw is not suitable for fastening to timber.

Vertical joint flashings can be used between the lamellas.

**Final execution must be according to the structural designer's instructions!**

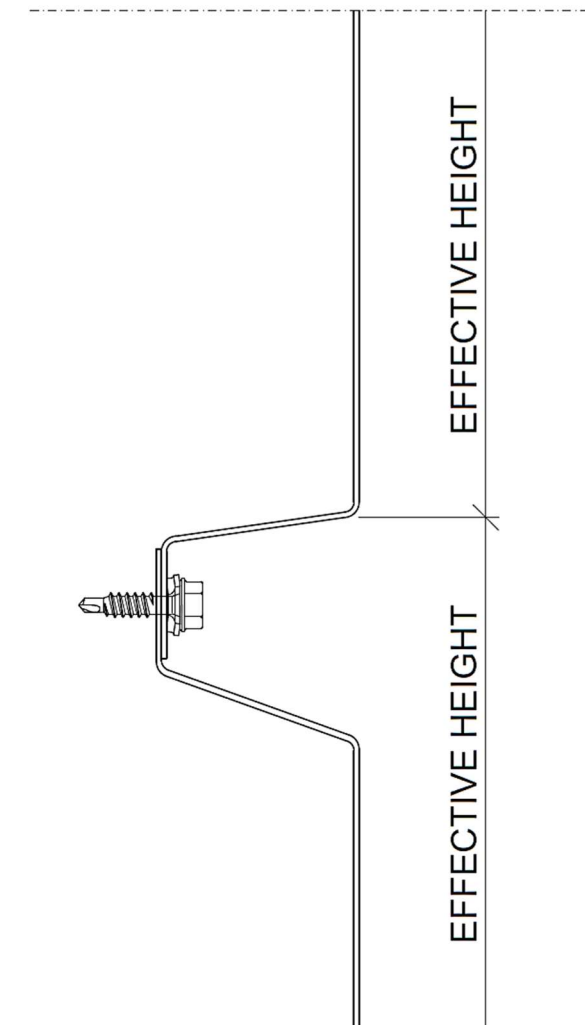

#### FOLLOW-UP OF THE DIMENSIONS

Follow the effective height. Check the dimensions from the plans!

#### Lamella tolerances:

- Effective height:  $\pm 2$  mm
- Width:  $\pm 2$  mm

#### Sub frame tolerances in horizontal direction:

- For one lamella:  $\pm 1$  mm
- Between each support stud:  $\pm 1$  mm

