

INSTRUCTIONS FOR FASTENING THE PANEL AND FOLLOW-UP OF THE DIMENSIONS

FACADE CLADDINGS / CLADDING LAMELLAS LAMELLA SHARP 40

RUKKI

FASTENING OF THE LAMELLA

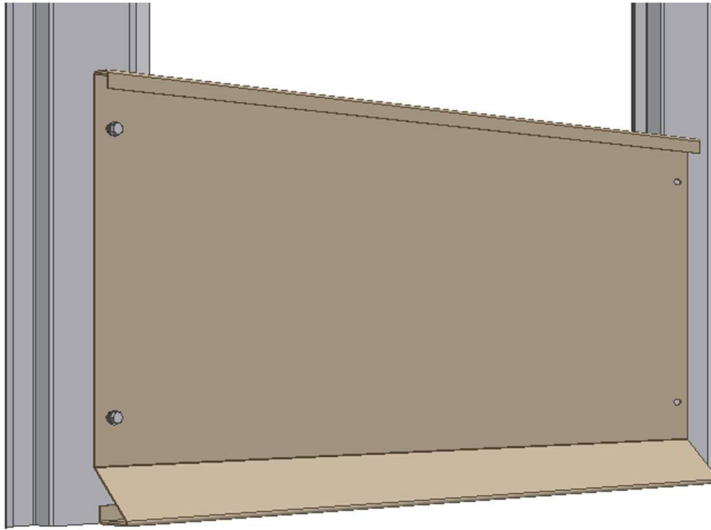

1. Add fasteners to one side of the lamella

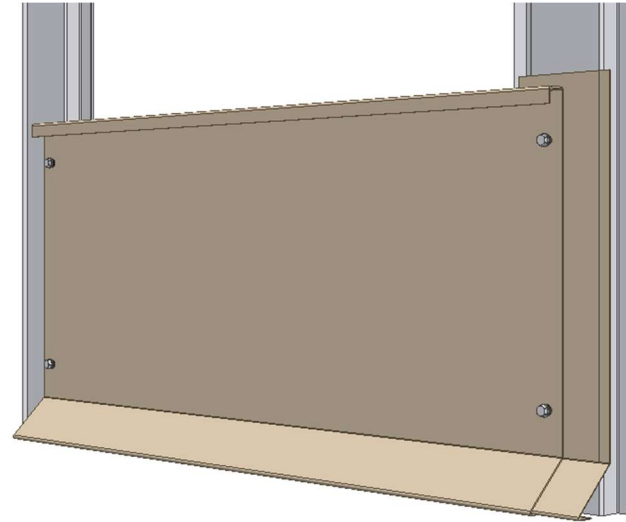

2. Add a joint piece and fasteners to the end of the lamella.

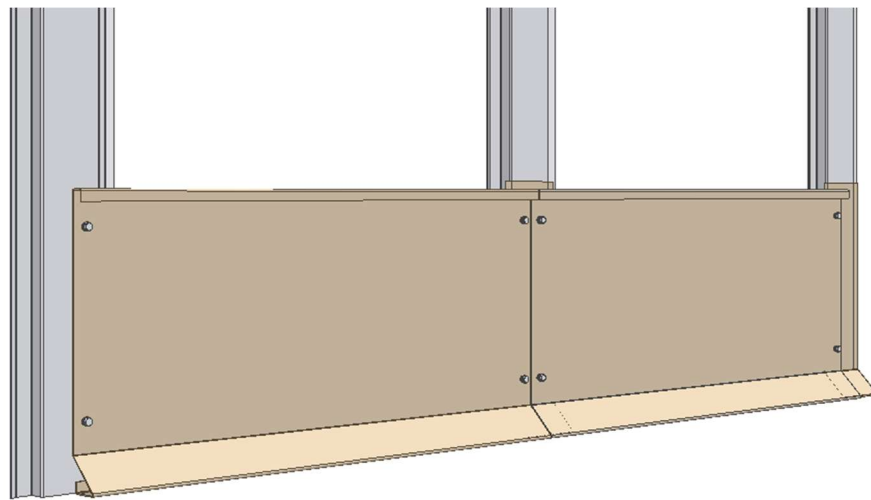

3. Continue with the next lamella, leave a 2-3 mm vertical gap between them for thermal expansion.

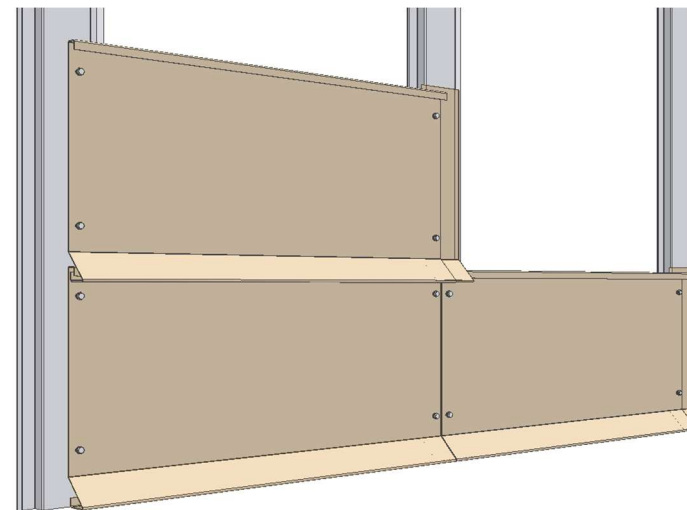

4. Install the next row as shown in the picture.

Recommended fasteners:

- For fastening to support stud (e.g. CA1SS1), use screws S3H48022D02S4C
→ Note: This screw is not suitable for fastening to timber.

Use joint piece CA1J1 between the lamellas.

Final execution must be according to the structural designer's instructions!

FOLLOW-UP OF THE DIMENSIONS

Follow the effective height. Check the dimensions from the plans!

Lamella tolerances:

- Effective height: ± 2 mm
- Width: ± 2 mm

Sub frame tolerances in horizontal direction:

- For one lamella: ± 1 mm
- Between each support stud: ± 1 mm

